



Modeling, Estimation and  
Control Conference 2023  
(Lake Tahoe, NV, Oct 2-5 2023)



# MECC 2023

South Lake Tahoe Transportation and Activity Guide

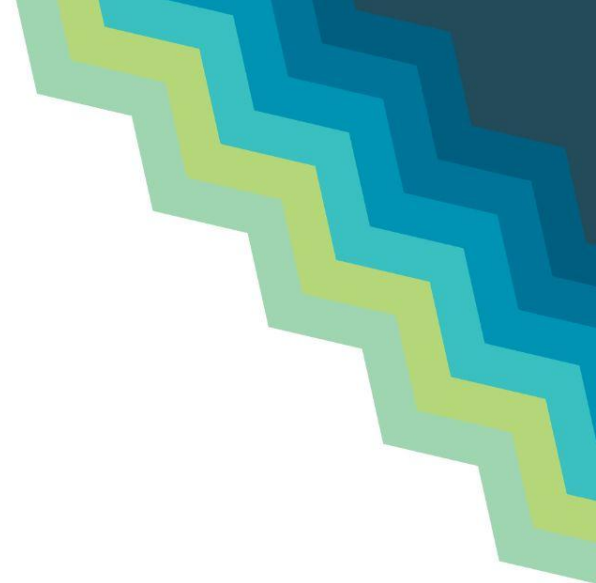

## **South Tahoe Airporter**

Get connected to Tahoe! South Tahoe Airporter provides daily shuttle service between Reno-Tahoe International Airport and South Lake Tahoe. We'll get you up the mountain with numerous departures to seven central locations. It's easy, fast, and affordable. All you need to do is kick back and enjoy the scenery.

Our mission is to provide safe, reliable, comfortable, and convenient ground transportation service between Reno-Tahoe International Airport and the hotels and casinos of Lake Tahoe. The South Tahoe Airporter team welcomes you to one of the most beautiful places on the planet and wishes you a memorable stay while you are here! Enjoy!



## **Pricing:**

One Way Adult: \$32.75

One Way Child: \$19.75

Round Trip Adult: \$59.50

Round Trip Child: \$35.58

## **Pick-up and Drop-off**

### **Locations:**

Reno Tahoe International Airport

Hard Rock Hotel & Casino

The Lodge at Edgewood

Harveys Lake Tahoe

Lake Tahoe Resort Hotel

Harrah's Lake Tahoe

Bally's Lake Tahoe

Learn more at:

<https://southtahoeairporter.com/>

## Lake Link

South Shore visitors and residents are getting a new way to get around with the launch of Lake Link, a microtransit shuttle system. The service will offer free rides in a zone including the casino corridor in Stateline, Nev., and Al Tahoe Boulevard and Pioneer Trail in South Lake Tahoe, Calif. The on-demand system will be accessed and scheduled through the Lake Link app and operate 365 days per year 7 a.m. to 9 p.m. and until 10 p.m. on Fridays and Saturdays in summer and winter. Funding for the shuttles is a collaboration of public and private partnerships. ([www.tahoelakelink.com](http://www.tahoelakelink.com)) "Lake Link is a new tool to help alleviate congestion in our tourist core and at some of the most popular recreation access points," said Raymond Suarez, Lake Link program manager. "It will connect visitors and residents to trails, beaches, entertainment, and nightlife, and be a resource for general commuters. This service will prove convenient, and by reducing vehicle traffic and getting more people to use public transit, we'll improve our environment and help protect the lake."

The shuttles carry 9-12 passengers and are equipped with bike and ski racks for the transportation of gear while riders are allowed to bring anything that can fit underneath the seat or in their lap. The fleet includes wheelchair-accessible shuttles, and riders can indicate on the app if they need certain accommodations. Children under the age of 16 must be accompanied by an adult to ride. Only service animals are allowed on the vehicles.



# LAKE LINK

## FREE, ON-DEMAND RIDES

### SERVICE HOURS

7AM - 9PM, SUN - THU  
7AM - 10PM, FRI - SAT

### SERVICE AREA

DOWNLOAD THE APP TO VIEW THE MAP

### HOW TO RIDE

REQUEST RIDES ON-DEMAND USING THE LAKE LINK APP

POWERED BY



GET IT ON  
Google Play

Download on the  
App Store

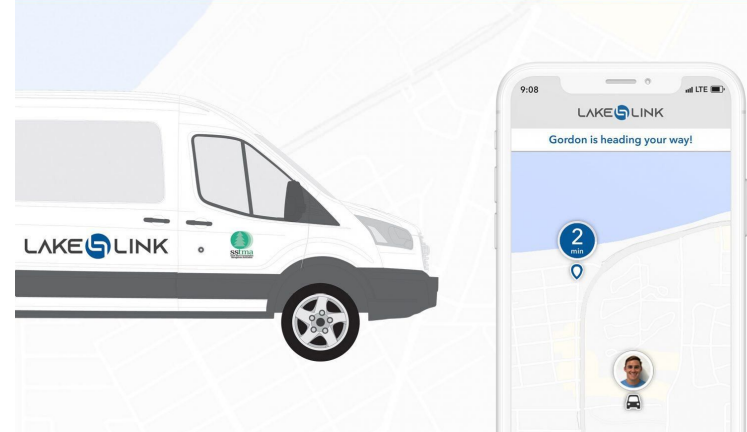

## Clearly Tahoe

Join Clearly Tahoe for an unforgettable adventure as you paddle through the crystal-clear waters and explore depths up to 75 feet below the surface!

Tours are suitable for all ages and skill levels (5+). This is an activity the whole family can enjoy together. Private tours are available for as few as two or as many as 80 guests.

Guests can choose from various experiences, including but not limited to the famous 1.5-hour Scenic Shoreline Tour, 2-hour East Shore Sunset Tour, or NEW LED stargazing experiences!

With an array of complimentary amenities and lifeguard-certified guides, we strive to provide a sense of safety and accommodation for our guests can relax and enjoy their time on the water.

Explore All Clearly Tahoe Experiences <https://clearlytahoe.com/tourlist/>  
Reservations can be made online at [www.clearlytahoe.com](http://www.clearlytahoe.com) or by contacting the reservation office at (530) 554-4664.

Instagram: <https://www.instagram.com/clearlytahoe/>

Facebook: <https://www.facebook.com/clearlytahoe/>





## MS Dixie

The M.S. Dixie II was built in Wisconsin, shipped in pieces (yes, it was a bit of a squeak through the Cave Rock tunnel just a few miles away from her home port) and launched in 1994. While she does get power from her paddles, the M.S. Dixie II also has propellers, which helps her churn a faster pace towards Emerald Bay and back and allows her to finish up to five cruises in a day, carrying over 500 passengers at full capacity. The captain will captivate you with some fun facts and local color stories on the trip west to the mouth of the Bay and then the real oohs and aahs from the passengers take over for the narration as the truly Emerald waters of the Bay cause you to pause breathing and the site of Vikingsholm Castle take you back to what it might be like in 1920 when Mrs. Lora Josephine Knight dynamited the rocks above to build a road that would allow her to complete what is considered one of the best examples of Scandinavian architecture in North America.





## **Biking**

The Pope-Baldwin Bike Path or Camp Richardson Bike Path is one of the most popular paved trails in the scenic Lake Tahoe area, as it winds through pine forest not far from the lakeshore. The trail parallels State Route 89 (Emerald Bay Road) for more than 3 miles, offering access to a number of local historic and recreational amenities.

The path also passes through the grounds of the historic Camp Richardson Resort, while the Tallac Historic Site, featuring three restored estates from the early 1900s, is a short trip up Heritage Way from the trail. Stop in at the Lake Tahoe (Taylor Creek) Visitor Center for more information on the local history and recreational opportunities or to stroll one of their many nature trails.

From the trail's eastern end, cyclists can continue on low-stress Eloise Avenue and Dunlap Drive to reach retail centers along SR 89 (Emerald Bay Road) and US 50 (Lake Tahoe Boulevard) in South Lake Tahoe.

### **Parking and Trail Access:**

Parking for the Pope-Baldwin Bike Path is available at the Lake Tahoe (Taylor Creek) Visitor Center on SR 89 (Emerald Bay Road) west of South Lake Tahoe. Additional parking can be found at Baldwin Beach and Pope Beach, but parking fees apply.



## Bike and Gear Rentals

Need to rent some gear for a day outside? Pine Nut Cafe and Anderson's Bicycle Rental have all you need to prepare for a day outdoors. Anderson's Bicycle Rental is located right at the start of the Pope-Baldwin Bike path, which has access to beaches, dining, historical sites, and more.

Just up the street is Pine Nut Cycle Cafe, a full service bike shop specializing in E-Bikes. Here you can shop for a new bike, get geared up with rental equipment, and fuel up with some cold pressed juice, coffee, and snacks. Pine Nut Cycle cafe is just a few minutes from the Pope-Baldwin bike path.

For something closer to our City Center, check out Tahoe Bike and Ski Company, located steps from Lakeview Commons. Discover beautiful beaches, public parks, and secluded meadows along with South Lake Tahoe's growing network of family-friendly bike paths. Their knowledgeable and friendly staff will help you select the perfect bike for your needs and give you information on great places to ride around South Lake Tahoe. They are ready to accommodate your group of any size.



## Van Sickle Bi-State Park

A short walk from the Stateline, NV casinos, Van Sickle Bi-State Park is one of the most accessible parks in the Tahoe Basin. A short climb from the trailhead quickly transports visitors to the serenity of the forest. The park's easy to moderate trails are studded with rock outcroppings that present grand views of the largest alpine lake in North America and the surrounding peaks. The Rim Trail Connector provides a tie-in to the famed Tahoe Rim Trail, designated by National Geographic Adventure magazine as one of the nation's top ten trails. The park is open to hikers, bicyclists, and equestrians. Open to pedestrians year-round, sunrise to sunset. Open to vehicles May 1 – October 31, sunrise to sunset. Entrance is free.





## Yosemite Axe Throwing

Yosemite Axe Throwing is complete with 10 throwing lanes in a beautifully constructed axe throwing facility. Each log was hand selected and each board was hand milled by Nate, as he does at all his locations, because of his passion to recreate an outdoor, mountain setting.

Yosemite Axe Throwing is not your typical axe throwing range. Nate Hodges, the owner and #2 ranked U.S. Stihl Timbersports Athlete has taken much pride in creating an environment that stands alone in the axe throwing world.

Yosemite Axe Throwing replicates an outdoor mountain axe throwing adventure that you will never forget. Using material for the targets and axe throwing lanes out of large Ponderosa pines and cedars locally salvaged from the devastation of the bark beetle & drought. The beautiful counter and bar tops were also rescued from a large cedar lost in the local Railroad Fire of 2017.

## **Flatstick Pub**

Flatstick Pub is a family-owned and operated indoor mini-golf bar and restaurant. The golf courses are intuitively created with both pros and novices in mind. If you're new to the game, don't worry you'll have a GREAT time.

Tahoe's only indoor mini golf bar, Flatstick Pub, aims to please the palates of locals and tourists by launching its new Mexican street food menu.

Flatstick Pub offers a 9-hole mini golf course, a full bar with an extensive local tap list, a proprietary golf-inspired game called Duffleboard™, and delicious food.







## **Heavenly Village Shopping**

Over 40 unique shops and eateries, offering a unique blend of local and national brands. Stroll the cobblestone sidewalks and browse through art & photo galleries, high-end clothing stores, sporting apparel & equipment, jewelry stores, 8-plex cinema or try ice skating or mini golf at our seasonal outdoor pavilion. The Shops at Heavenly have it all and more.

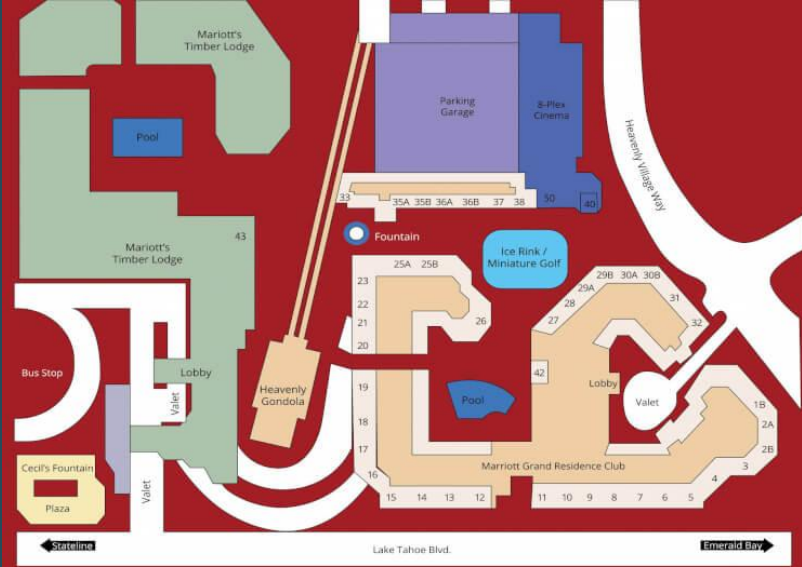

Fire + Ice

Heavenly Village Cinema

1A - Driftwood Cafe

1B - Blue Pebbles

2A - Sunglass Hut

2B - California Burger Co.

3 - Social House Craft Sandwiches

4 - Azul Latin Kitchen

6 - Up Shirt Creek

7 - Old Time Photo

8 - Earth Bound Trading Co.

9 - Eadington Gallery

10 - Nestlé Toll House

11 - All About Tahoe Diamond Resorts

12 - Serenity Spa

13 - Sealed with A Kiss

14 - High Chapparel

15 - Boot Banditos

16 - Patagonia

17 - Heavenly Mountain Ski & Ride School

18 - Heavenly Sports

19 - Powder House

20 - Rocket Fizz

21 - Shirt off my Back

22 - Heaven's Little Cafe

23 - Coldstone Creamery

25 - Base Camp Pizza Co.

26 - Kalanis

27 - Sock City

28 - Poe Rave Jewelry Company

29A - Pacific Crest Gallery

30A - Activity Zone

30B - Rocky Mountain Chocolate Factory

31 - Little Blue House by Hadley

32 - Perfectly Polished Nail

33 - Gunbarrel Tavern & Eatery

35A - Starbuck's

36A -

36B - On Tahoe Time

37 - Paradise Timeshare Resale

38 - Beans and Bikinis

38 - Village Toys

41 - The Loft Theatre & Restaurant

Heavenly Village Map





Visit  
**lake  
tahoe**

**Stateline & Heavenly Village  
Meeting Space & Eatery Map**

**MEETINGS PROPERTIES**

- Harrah's Hotel & Casino
- Harvey's Hotel & Casino
- Hard Rock Hotel & Casino
- Bally's Resort & Casino
- Lake Tahoe Resort Hotel
- Basecamp Hotel Lake Tahoe
- The Lodge at Edgewood Tahoe
- The Landing Tahoe Resort & Spa
- The Loft Tahoe
- Forest Suites
- Hotel Becket
- Marriott's Grand Residence Club
- Coachman Hotel

**RESTAURANTS**

- 1 Aces High Saloon & Smokehouse
- 2 Azul Latin Kitchen
- 3 The Beach House
- 4 Base Camp Pizza Co.
- 5 Blue Dog Gourmet Pizza
- 6 California Burger Company
- 7 Driftwood Cafe
- 8 FIRE+ICE
- 9 Gunbarrel Tavern & Eatery
- 10 Kalani's
- 11 Lake Tahoe AleworX
- 12 Lucky Beaver Bar & Burger
- 13 McP's Taphouse Grill
- 14 Raley's Supermarket
- 15 South of North Brewing Co.
- 16 Stateline Brewery & Restaurant
- 17 Taste of Europe
- 18 Ten Crows BBQ

Van Sickle  
Bi-State Park



www.VisitLakeTahoe.com

Downtown area Walking Map

Visit  
lake  
tahoe

## PLAN YOUR VISIT

Find local  
restaurants, hotels,  
attractions & more

Plan from your  
desktop & take it with  
you on the app

Get routed directions

Share your plan with  
friends



### Visit Lake Tahoe Trip Planning App

Planning the perfect getaway in South Lake Tahoe just got much easier! We're excited to unveil the Lake Tahoe Guide on our site with integrated mobile app, an interactive way to map out everything you don't want to miss in Lake Tahoe. Designed with our partners at Visit Widget, this tool provides a new way to explore what the city has to offer, including hotels, popular restaurants, activities, and shopping. View it all at once or search by categories like Beaches, Golf, & Campgrounds.

Download the **APP** today and start **planning** your stay

Visit  
lake tahoe